

Huzhou Zhongrui Cleaning

TUBE FITTING



ZR CLAMPING TUBE FITTING

Straight Union

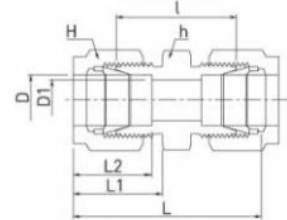

D		D1	h	H		L2	L1		L	
in	mm	min		in	mm					
1/8	3.17	2.28	7/16	11.11	7/16	11.11	12.7	15.24	22.35	35.56
3/16	4.76	3.04	7/16	11.11	1/2	12.7	13.71	16	24.13	37.33
1/4	6.35	4.82	1/2	12.7	9/16	14.28	15.24	17.78	26.16	40.89
5/16	7.93	6.35	9/16	14.28	5/8	15.87	16.25	18.54	28.19	42.92
3/8	9.52	7.11	5/8	15.87	11/16	17.46	16.75	19.3	30.22	44.95
1/2	12.7	10.41	13/16	20.63	7/8	22.22	22.86	21.84	30.98	51.3
5/8	15.87	12.7	15/16	23.81	1	25.4	24.38	21.84	31.75	52.07
3/4	19.05	15.74	1-1/16	26.98	1-1/8	28.57	24.38	21.84	33.27	53.59
7/8	22.22	18.28	1-3/16	30.16	1-1/4	31.75	25.9	21.84	35.05	55.37
1	25.4	22.35	1-3/8	34.92	1-1/2	38.1	31.24	26.41	40.38	64.77

Union Elbow

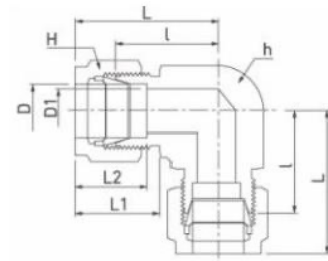

D		D1	h	H		L2	L1	[L	
in	mm	min		in	mm					
1/8	3.17	2.28	3/8	9.52	7/16	11.11	12.7	15.24	15.74	22.35
3/16	4.76	3.04	1/2	12.7	1/2	12.7	13.71	16	17.78	24.38
1/4	6.35	4.82	1/2	12.7	9/16	14.28	15.24	17.78	19.55	26.92
5/16	7.93	6.35	9/16	14.28	5/8	15.87	16.25	18.54	21.33	28.7
3/8	9.52	7.11	5/8	15.87	11/16	17.46	16.75	18.54	23.11	30.48
1/2	12.7	10.41	13/16	20.63	7/8	22.22	22.86	19.3	25.9	36.06
5/8	15.87	12.7	15/16	23.8	1	25.4	24.38	21.84	28.7	38.8
3/4	19.05	15.74	1-1/16	26.98	1-1/8	28.57	24.38	21.84	29.7	39.87
7/8	22.22	18.28	1-1/4	31.75	1-1/4	31.75	25.9	21.84	34.54	44.7
1	25.4	22.35	1-27/64	36.12	1-1/2	38.1	31.24	26.41	36.83	49.02

ZR CLAMPING PIPE FITTING

Union Tee

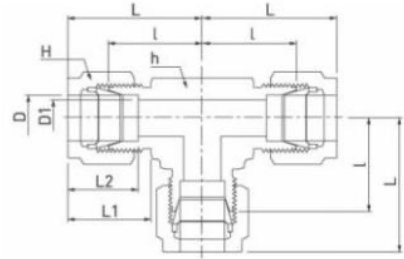

D		D1	h		H		L2	L1		L
in	mm	min	in	mm	in	mm				
1/8	3.17	2.28	3/8	9.52	7/16	11.11	12.7	15.24	15.74	22.35
3/16	4.76	3.04	1/2	12.7	1/2	12.7	13.71	16	17.78	24.38
1/4	6.35	4.82	1/2	12.7	9/16	14.28	15.24	17.78	19.55	26.92
5/16	7.93	6.35	9/16	14.28	5/8	15.87	16.25	18.54	21.33	28.7
3/8	9.52	7.11	5/8	15.87	11/16	17.46	16.75	19.3	23.11	30.48
1/2	12.7	10.41	13/16	20.63	7/8	22.22	22.86	21.84	25.9	36.06
5/8	15.87	12.7	15/16	23.8	1	25.4	24.38	21.84	28.7	38.8
3/4	19.05	15.74	1-1/16	26.98	1-1/8	28.57	24.38	21.84	29.71	39.87
7/8	22.22	18.28	1-1/4	31.75	1-1/4	31.75	25.9	21.84	34.54	44.7
1	25.4	22.35	1-27/64	36.12	1-1/2	38.1	31.24	26.41	36.83	49.02

Union Cross

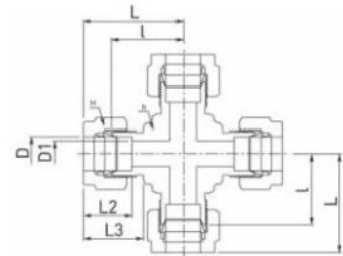

D		D1	h		H		L2	L3		L
in	mm	min	in	mm	in	mm				
1/16	1.59	1.27	3/8	9.52	5/16	7.93	8.63	10.92	14	17.88
1/8	3.17	2.28	3/8	9.52	7/16	11.11	12.7	15.24	15.74	22.35
3/16	4.76	3.04	1/2	12.7	1/2	12.7	13.71	16	17.78	24.38
1/4	6.35	4.82	1/2	12.7	9/16	14.28	15.24	17.78	19.55	26.92
5/16	7.93	6.35	9/16	14.28	5/8	15.67	16.25	18.54	21.33	28.7
3/8	9.52	7.11	5/8	15.87	11/16	17.46	16.67	19.3	23.11	30.84
1/2	12.7	10.41	13/16	20.64	7/8	22.22	22.86	21.84	25.9	36.06
5/8	15.87	12.7	15/16	23.81	1	25.4	24.38	21.84	28.7	38.8
3/4	19.05	15.74	1-1/16	26.98	1-1/8	28.58	24.38	21.84	29.71	39.87
7/8	22.22	18.28	1-1/4	31.75	1-1/4	31.75	25.9	26.41	34.54	44.7
1	25.4	22.35	1-27/64	36.12	1-1/2	38.1	31.24	26.41	36.83	49.02